

## Access

### ●Car Access (set destination system for "Iwaisaki")

[From Sendai]  
Ten minutes north on Route 45 from Oya Kaigan Interchange of Sanriku Expressway  
(It is not possible to get on or off the road to Sendai from Iwaisaki Interchange)  
[From Iwate]  
Head south on Route 45, then it's two minutes after the Iwaisaki Iriguchi  
(Free parking is available)  
Parking lot has space for 55 cars, 2 disabled spots, and 15 mid-to-large buses.

### ●Access by Public Transportation (BRT)

About 3 minutes by taxi from JR Rikuzen-Hashikami Station  
(20 min on foot)

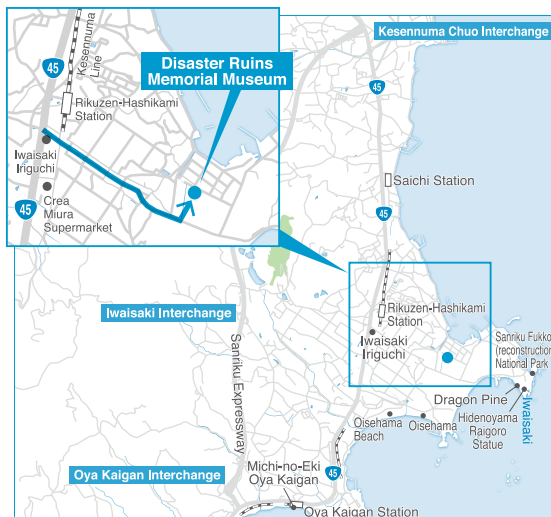

**Hajikamisemukai 9-1, Kesennuma City,  
Miyagi Prefecture 988-0246 Japan**  
URL → <http://www.kesennuma-memorial.jp/>  
E-mail → [info@kesennuma-memorial.jp](mailto:info@kesennuma-memorial.jp)  
TEL.0226-28-9671 FAX.0226-28-9675

## Nearby Attractions

(Sanriku Fukko (reconstruction) National Park – Iwaisaki)

Iwaisaki is the southern entry point of the Sanriku Geopark and features many interesting natural attractions such as the Shiofuki-iwa (coastal rocks with dramatic salt-spray from waves) and the Dragon Pine (a pine tree that looks like a dragon). There is also a place where visitors can try making salt the old fashioned way by boiling seawater.



Shiofuki-iwa



Dragon Pine

## Opening Hours

**April–September 9:30am to 5:00pm** (last entry is 4:00pm)

**October to March 9:30am to 4:00pm** (last entry at 3:00pm)

(Please see our website for information on reserving the entire hall)

## Closed

- Every Monday  
(Open when Monday is a national holiday and closed the following day)
- The day after national holidays  
(except weekends and Golden Week)
- Year-end holidays (December 29 to January 4)  
(For information on other days when the museum is closed, please see the website)

## Special Days (open regardless of day of the week or holiday status)

- 11th day of every month
- September 1 (Disaster Prevention Day),  
November 5 (World Tsunami Awareness Day)

## Admission

Type	Individual	Group (of 30 or more – by reservation)
Adult	¥600	¥500
Age 16-18	¥400	¥300
Age 6 -15	¥300	¥200

(Age 5 and under are free)

(People who display a Physical Disability Certificate get 50% off admission)

## Programs (Optional Menu – By Reservation)

The following programs are available for groups using the facility for educational field trips or observation and study

- Storyteller Guide:  
Gives a tour of the facility and passes on the lessons from the disaster
- Disaster Readiness Seminar:  
Teaches what to do to prepare and during a disaster

Type	Storyteller Guide	Disaster Readiness Seminar
(time required)	(90 min)	(60 to 90 min)

**School Visits ¥3,000 (1 to 20 ppl) ¥8,000and up (10 to 50 ppl)**

**Adult Groups ¥6,000 (1 to 20 ppl) ¥10,000and up (10 to 50 ppl)**

(Program fees are not included in admission.)

(The facility can handle a maximum of 200 people, See the website for details.)

# Ruins of the Great East Japan Earthquake Kesennuma City Memorial Museum

The Great East Japan Earthquake of March 11, 2011, the great tsunami that followed, and the subsequent large fires caused Kesennuma City to experience a terrible tragedy, with 1,152 dead (including earthquake-related deaths) and 214 missing persons.

The goal of the Ruins of the Great East Japan Earthquake Kesennuma City Memorial Museum is to preserve the memories and lessons of the disaster for the future, to keep alarm bells ringing and be a visible record, contributing to Kesennuma City's target of zero tsunami deaths.

# Guidebook

## Flow of Tour

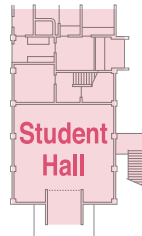
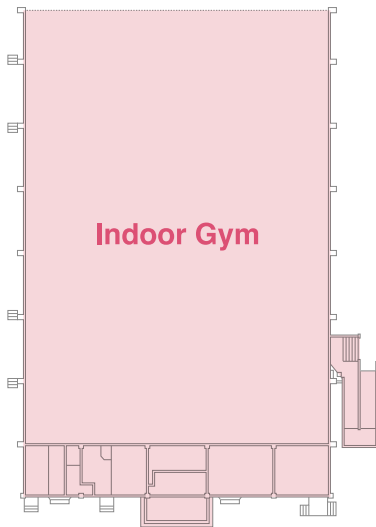

11 Destroyed wall



12 Car pile-up

### Disaster ruins – Entry is restricted

Everything is restricted except for: North School Building 1F hallway, South School Building 1F hallway, parts of 3F, 4F, and the roof.

## 1 Memorial Museum

### Entrance

- ① Buy a ticket at the **counter**

### Video and Exhibition Zone

- ② **Video Theatre** (300 inch screen)
  - ◇ Videos of the disaster and directly afterwards
- ③ **Exhibition Room A**
  - ◇ Threats and Scars from Earthquakes and Tsunami
- ④ Go through the passage to the Disaster Ruins area



## 2 Disaster Ruins

(Former Kesennuma Koyo High School Building)

### Former South School Building

- ⑤ **1F** – Destroyed school building
- ⑥ Go to 3F via stairs or elevator
- ⑦ **3F** – Car swept away in the tsunami
- ⑧ **4F** – Tsunami high water mark
- ⑨ **Roof** – Evacuation Spot
- ⑩ Return to 1F via stairs or elevator

### Outdoors

- ⑪ **West side of south school building**
  - Destroyed wall
- ⑫ **In front of the General Practice Building**
  - Car pile-up

### Former North School Building

- ⑬ Go through **1F** hallway to Memorial Hall

## 3 Memorial Museum

### Video and Exhibition Zone

- ⑭ **Exhibition Room B**
  - ◇ Threats and Scars from Earthquakes and Tsunami II
  - ◇ Rescue and search for missing people
  - ◇ Scenes from the evacuation centers
  - ◇ Life in temporary housing
- ⑮ **Lecture Room**
  - ◇ Message from victims – The value of life
- ⑯ **Display Corner**
  - ◇ Record of the Great East Japan Earthquake and the Journey to Recovery

### Rental Space

- ⑰ **Training Room**
- ⑱ **Workshop and Communication Hall**

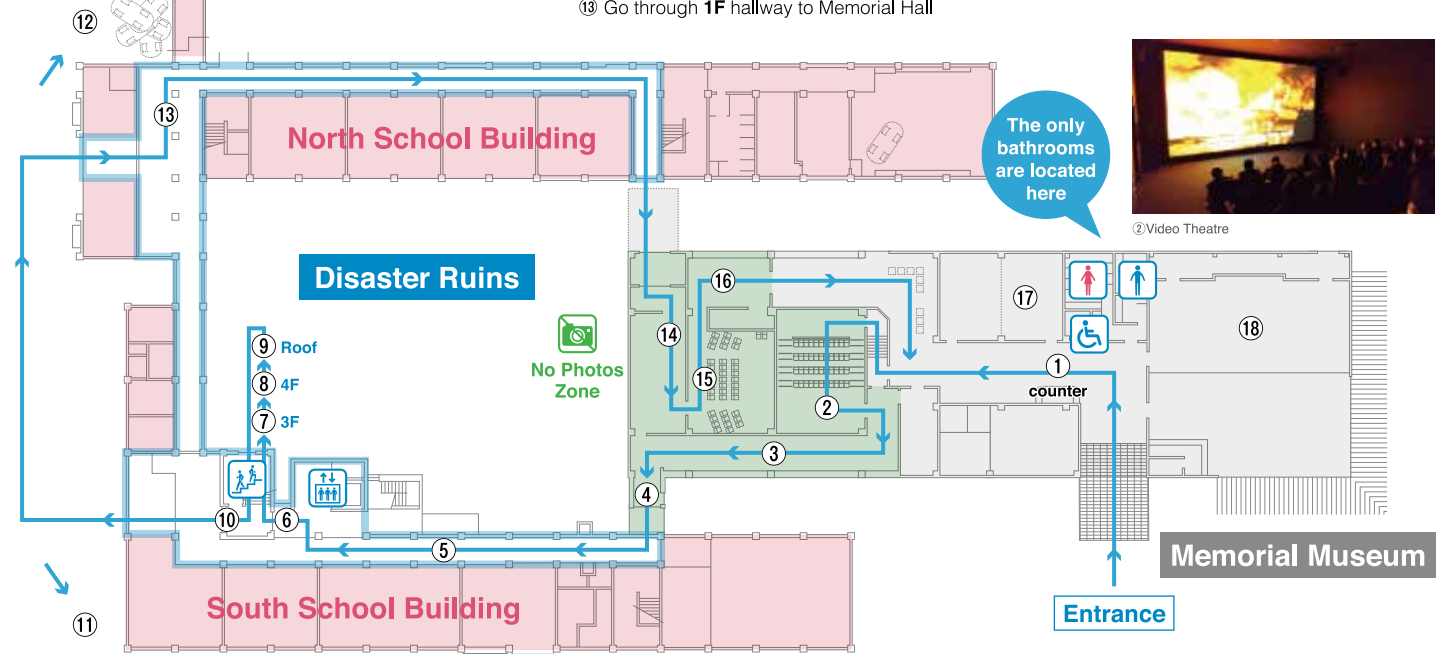

## Q & A

**Q1** Is it alright to take pictures?

**A1** It is alright to take pictures everywhere except for the “No Photos Zone” inside the Memorial Hall

**Q2** Is there a bathroom in the Disaster Ruins area?

**A2** There are bathrooms in one location only, inside the Memorial Hall. Sorry for the inconvenience.

**Q3** Are the explanations available in Japanese only?

**A3** With use of smartphone technology, English, Chinese, Korean, and Bahasa Indonesia are available.

**Q4** How long does it take to do a tour?

**A4** Tours take about 60 to 90 minutes. However, it is possible to go straight to the disaster ruins without stopping at the video theatre.

**Q5** Is it possible to eat, drink, and/or smoke on the facility grounds?

**A5** It is possible to eat and drink in the entrance and the rental space. However, the entire facility is no smoking, and there are no smoking areas provided.